

REVISIONS			
REV	DESCRIPTION, ECN, EAR NO.	DATE	APP'D
A	INITIAL DRAWING	OCT08/14	L.C.
B	REMOVE LOGO	JUN18/25	K.T.

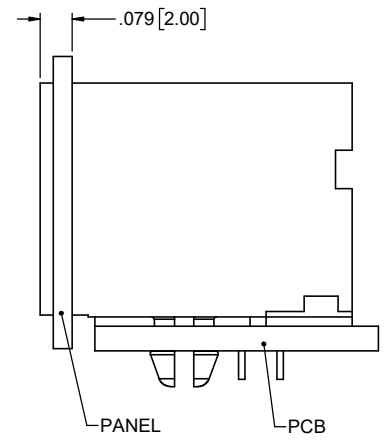

RECOMMENDED PANEL CUTOUT

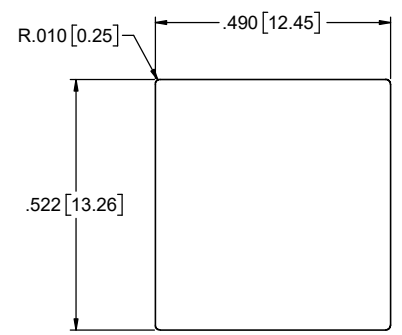
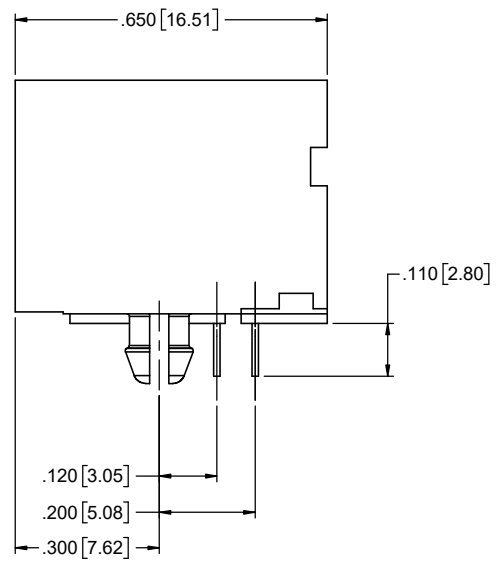
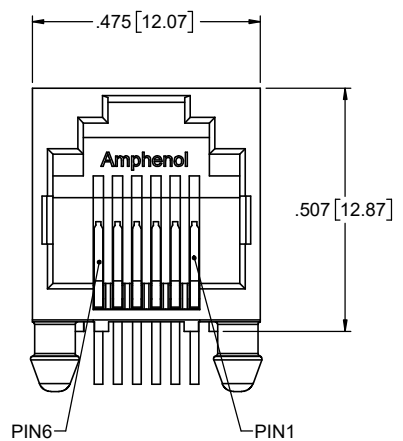
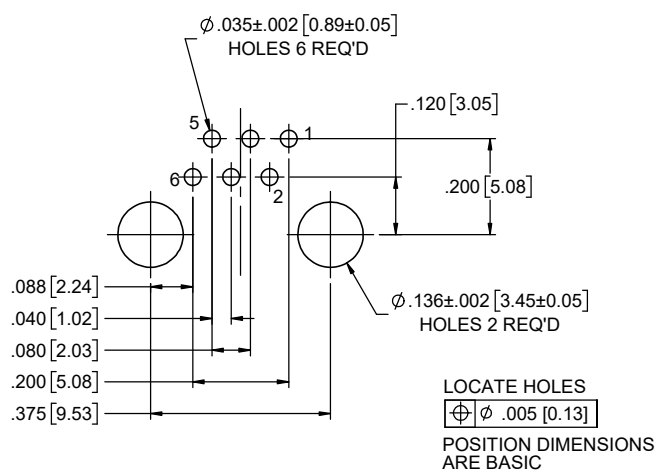

RECOMMENDED P.C.B. LAYOUT  
(COMPONENT SIDE OF BOARD)  
TOLERANCE:  $\pm .002 [0.05]$

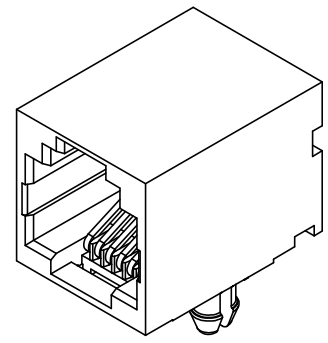

**NOTES:**

1. PLASTIC HOUSING: HIGH TEMPERATURE THERMOPLASTIC  
UL FLAMMABILITY RATING 94V-0, COLOR: BLACK.  
  
CONTACTS: PHOSPHOR BRONZE  
CONTACT PLATING: GOLD ON MATING SURFACES.  
SEE PART NUMBER FOR THICKNESS OPTIONS.  
50 MICROINCHES [1.27 MICRONS]  
MINIMUM NICKEL OVER ALL  
100 MICROINCHES [2.54 MICRONS]  
MATTE TIN ON CONTACT TAILS.
2. RECOMMENDED SOLDERING TEMPERATURE:  
WAVE SOLDERING AT 260 °C MAXIMUM FOR 5-8 SEC MAXIMUM.

PART NUMBER: RJE01-X60-01

GOLD PLATING  
1 = 6 $\mu$ "  
6 = 50 $\mu$ "  
G = 15 $\mu$ "  
J = 30 $\mu$ "



UNLESS SPECIFIED OTHERWISE	DRAWN Frank W	OCT08/14
PRIMARY UNITS INCHES	CHECKED L.CHAN	OCT08/14
SECONDARY MILLIMETERS	M.E. APP'D	
REFERENCE IN PARENTHESES	Q.A. APP'D	
GENERAL TOLERANCES	DWG APPR.	
1 DECIMAL PLACE $\pm .025$	ENG. REL. NO.	
2 DECIMAL PLACES $\pm .020$	REF.	
3 DECIMAL PLACES $\pm .015$	THIRD ANGLE PROJECTION	DO NOT SCALE DRAWING
ANGULAR DEGREES $\pm 1.0^\circ$		

**Amphenol Canada Corp.**  
Commercial Products

MODULAR JACK, RJ11, SINGLE PORT, 6 POSITIONS,  
6 CONTACTS WITHOUT SHIELD, RoHS COMPLIANT

DWG. NO. P-RJE01-X60-01 REV B

CODE ID NO. 03554 DWG SIZE: X SCALE: 5:1 SHEET 1 OF 1